

# Monobarb Adapters

## Non-Metallic Sanitary Tubing Adapters



Secure sanitary tubing attachments that are easy to use and quick to assemble are critical in numerous low-pressure laboratory, biotechnology and pharmaceutical applications. Contamination of fluids and product loss through leakage can be costly. Monobarb Sanitary Fittings provide a superior connection to tubing through a single-barb construction, reducing the potential for leakage. In addition, tubing clamps secure to the fittings behind the barbed area, which limits the risk of flexible tubing being cut from a sharp, barbed edge and provides for attachment to a smooth surface.

Molded seams and abrupt angles, frequently found in other fitting designs, can cause turbulence ("dead space") or stagnation of fluid flow, creating areas for potential bacterial growth. Monobarb Fittings are entirely free of these seams and angles, eliminating both potential problems. The exterior surface of Monobarb Fittings is designed to reduce potential contamination from wicking fluids by eliminating seams near fluid entry points. Each fitting has a gradual taper between the inlet and the main body of the connector. This taper, along with an ultra-smooth inner surface, permits a more even and undisturbed passage of fluid, and facilitates complete cleaning.

Sani-Tech West provides a full line of Monobarb fittings in polypropylene; as well as custom materials like PVDF. Monobarb Sanitary Fittings have been engineered to provide a sanitary connection point for fluids transported through flexible tubing. Sani-Tech West supplies a broad line of flexible tubing formulations that are ideally suited for use in conjunction with these sanitary fittings — Contact us today with your sanitary applications.

## BIOPHARMACEUTICAL PRODUCTS

*Monobarb Sanitary Fittings are designed for use with flexible tubing in low-pressure sanitary applications.*

### Features/Benefits

- **Smooth Inner Surface Limits Particle Entrapment**
- **Streamlined Fluid Path Improves Flow of Sensitive Fluids**
- **Monobarb Design Helps to Ensure Secure Tubing Connections**
- **One-Piece Construction Minimizes Risk of Leakage**
- **Produced from Polypropylene, Meets USP Class VI**

### Typical Applications

- **Media Mixing Containers**
- **Bioreactors**
- **Fermentors**
- **Bioprocess Containers**
- **Filtration and Purification Systems**
- **Sample Ports**
- **Filling Machines**
- **Flexible Packaging Systems**

# Monobarb Adapters

## Non-Metallic Sanitary Tubing Adapters

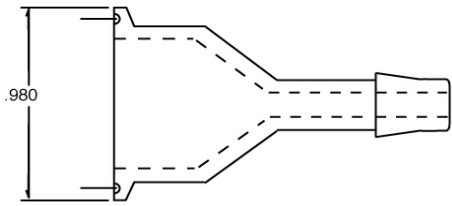

MINI TRI-CLAMP x MONOBARB	
SIZE	PART #
MINI TC x 1/4" MONOBARB	TADP075-04MOB
MINI TC x 3/8" MONOBARB	TADP075-06MOB
MINI TC x 1/2" MONOBARB	TADP075-08MOB
MINI TC x 3/4" MONOBARB	TADP075-12MOB
MINI TC X 1" MONOBARB	TADP075-16MOB

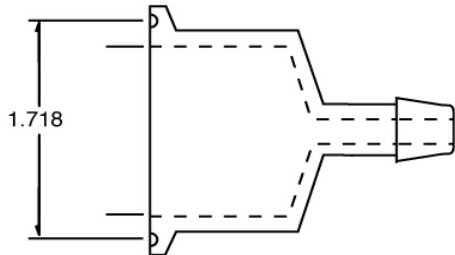

1 1/2" TRI-CLAMP x MONOBARB	
SIZE	PART #
1 1/2" TC x 1/4" MONOBARB	TADP150-04MOB
1 1/2" TC x 3/8" MONOBARB	TADP150-06MOB
1 1/2" TC x 1/2" MONOBARB	TADP150-08MOB
1 1/2" TC x 3/4" MONOBARB	TADP150-12MOB

### Typical Properties

### Polypropylene

#### Physical

Density -Specific Gravity (ASTM D 792) (Method B)	0.900 sp gr 23/23°C
Melt flow rate (ASTM D 1238) (230°C/2.16kg)	4.00 g/10 min

#### Mechanical

Tensile Strength @ Yield (ASTM D 638) (2 in/min) (50 mm/min)	4000 psi 28 MPa
Flexural Modulus (ASTM D 790) (0.05 in/min, 1% Secant, Procedure A) (1 mm/min, 1% Secant, Procedure A)	180000 psi 1240 MPa
Tensile Elongation @ Yld (ASTM D 638)	8.0 %

#### Impact

Notched izod impact (ASTM D 256) (73 °F, Method A) (23 °C, Method A)	1.9 ft-lb/in 101 J/m
--	-------------------------

#### Hardness

Rockwell R (ASTM D 785)	82
Shore D	72

#### Thermal

DTUL @66psi - Unannealed (ASTM D 648)	91 °C
Melting Temperature °F (°C)	340°F (171°C)
Heat Deflection °F (°C) @66 psi °F (°C) @264 psi	185°F (84°C) 135°F (57°C)
Autoclavable	Yes to 240° F (115°C)

#### Approvals

FDA 21 CFR 177.1520, USP VI, USDA, 3A

#### Additional Properties

Refractive Index (nD)	1.49
Water Absorption (in 24 hrs, %)	0.01
Drop Weight Impact Strength, Basell Test Method, -29°C	26 ft-lbs