



# NTR™ BLEED & SAMPLE VALVES

FEATURING TWIST-N-POP™ TECHNOLOGY



## BIOPHARMACEUTICAL PRODUCTS

*High Purity In-Line, Angle,  
Bleed & Sample Valves*

### Features/Benefits

- **NTR Technology = No Tools Required Provides Easy Assembly & Disassembly**
- **316L Stainless Steel Construction**
- **20RA/EP Standard**
- **BPE Compliant Materials**
- **PT Silicone + PTFE/TFM Rebuild Kits**
- **High Temperature Polyetherimide Handle**
- **Autoclavable**
- **S.I.P. - C.I.P. Sterilizable**
- **No Dead Leg**
- **Color Coding Options Available**

### Typical Applications

- **Transfer Panel Drain Caps**
- **Continuous Bleed Water Drops**
- **Housing/Pump Air Bleed**
- **Sampling**
- **Titrations**
- **Media Applications**

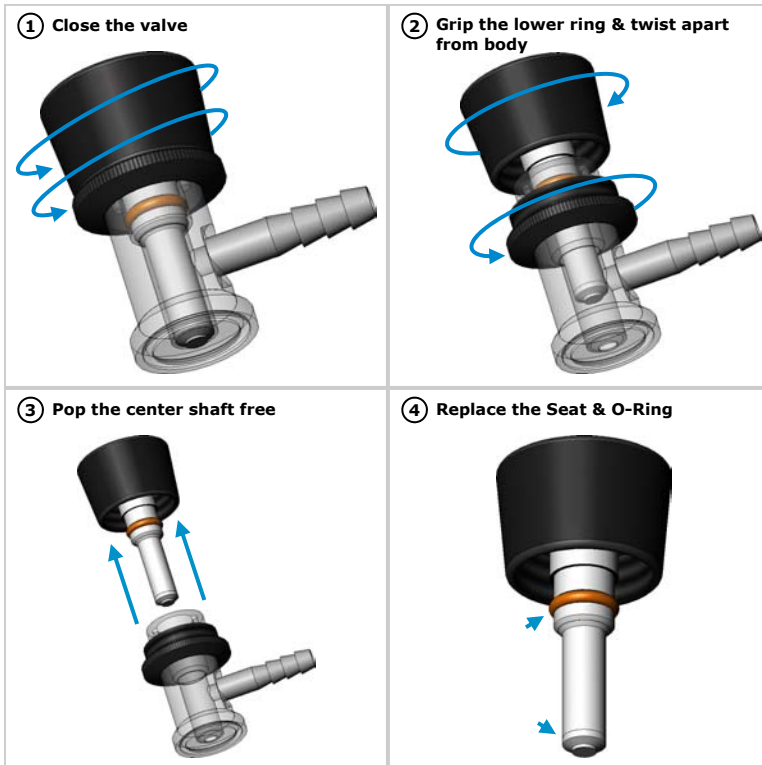

**sani-tech**  
**west**

321 Irving Drive  
Oxnard, CA 93030  
(800) 726-4835  
www.sani-techwest.com

