

Sanitary/Sanitary Step Up Tri-Clamp® Fitting

Fitting Specifications

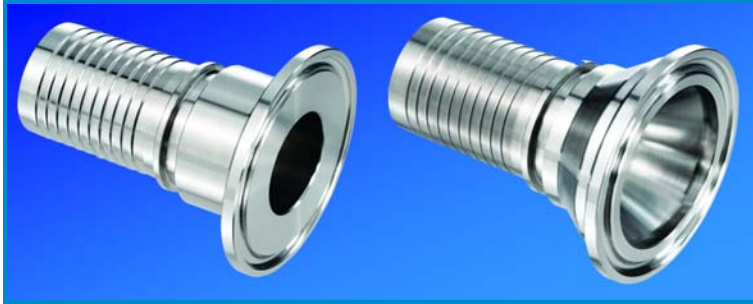

Style 10/10U

Description

Step-up styles are designed with "blended" internal surfaces to prevent material build-up or entrapment. Gasket face dimensions are standard to industry specifications.

Materials

- Type 316L Stainless Steel standard.
- Polypropylene, PVDF & other materials available by special order.

Temperature/Pressure rating

Pressure and temperature ratings of sanitary assemblies are dependant upon clamp pressure ratings and gasket material temperature ratings. Generally clamps are pressure rated as follows:

Standard Weight Style

150 PSIG @ 70°F
125 PSIG @ 250°F

Heavy Weight Style

500 PSIG @ 70°F
250 PSIG @ 250°F

High Pressure Bolt Style

1500 PSIG @ 70°F
1200 PSIG @ 250°F

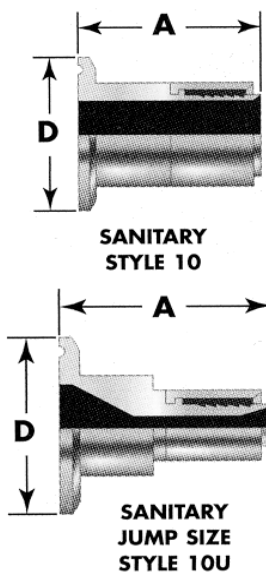

Sanitary Specifications Style 10 and 10U

Hose Size ID (in.)	Part Number	Description	ID (in.)	Flange Diameter 'D' (in.)	Overall Length 'A' (in.)
1/4	160410SKO	1/4" x 1"	0.19	1.98	1.46
3/8	160610SKO	3/8" x 1"	0.30	1.98	1.85
1/2	160810SKO	1/2" x 1"	0.40	1.98	2.19
1/2	160810USK	1/2" x 1 1/2"	0.40	1.98	2.22
3/4	381210SKO	3/4" x 1"	0.65	1.98	2.39
3/4	381210USK	3/4" x 1 1/2"	0.65	1.98	2.39
1	381610SKO	1" x 1"	0.87	1.98	2.39
1	381610USK	1" x 1 1/2"	0.87	1.98	2.45
1 1/2	382410SKO	1 1/2" x 1 1/2"	1.37	1.98	3.125
1 1/2	382410USK	1 1/2" x 2"	1.37	2.490	2.40
2	383210SKO	2" x 2"	1.75	2.490	3.980
2 1/2	384010SKO	2 1/2" x 2 1/2"	2.20	3.050	4.200
3	384810SKO	3" x 3"	2.76	3.580	4.400
4	386410SKO	4" x 4"	3.75	4.675	5.000

Tri-Clamp® is a registered trademark of Alfa Laval Inc.



321 Irving Drive
Oxnard, CA 93030
(800) 726-4835
www.sani-techwest.com

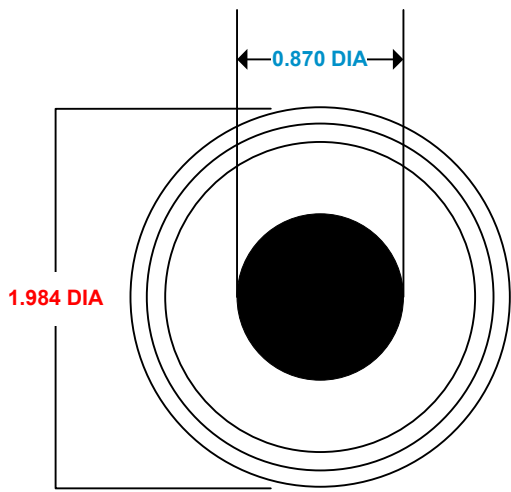

1" LADDISH Tri-Clamp

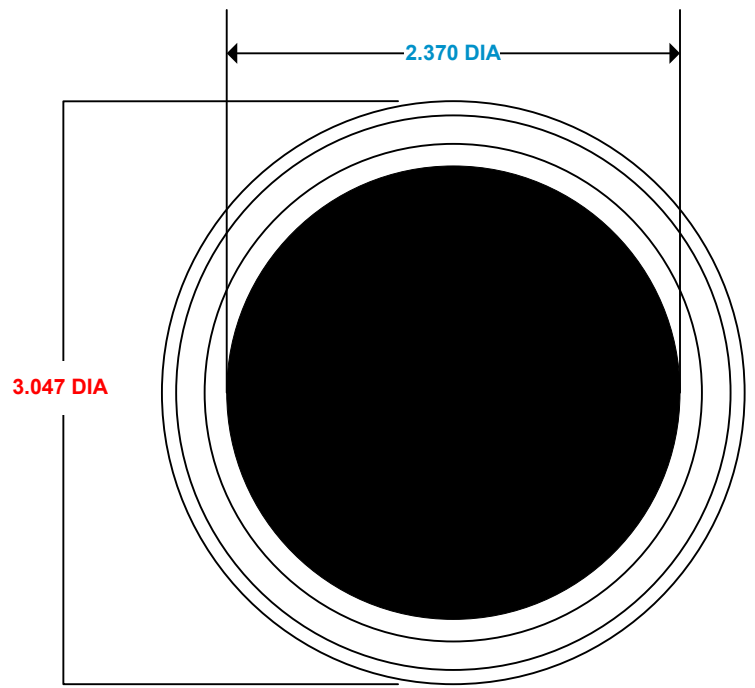

2 1/2" Tri-Clamp

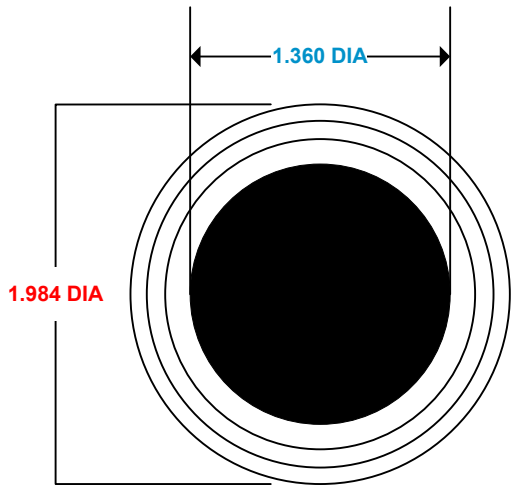

1 1/2" Tri-Clamp

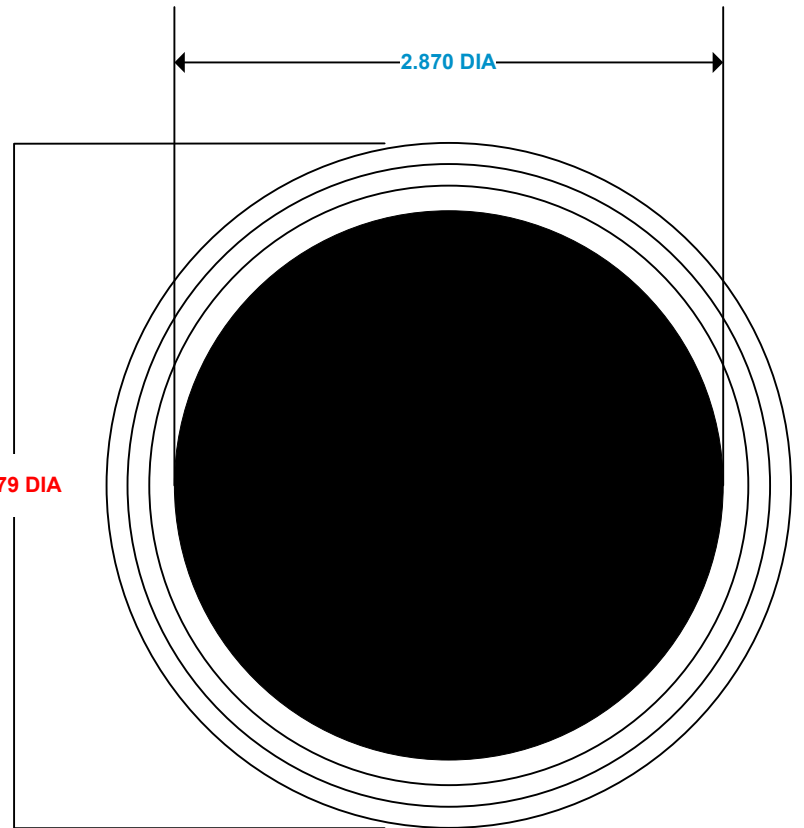

3" Tri-Clamp

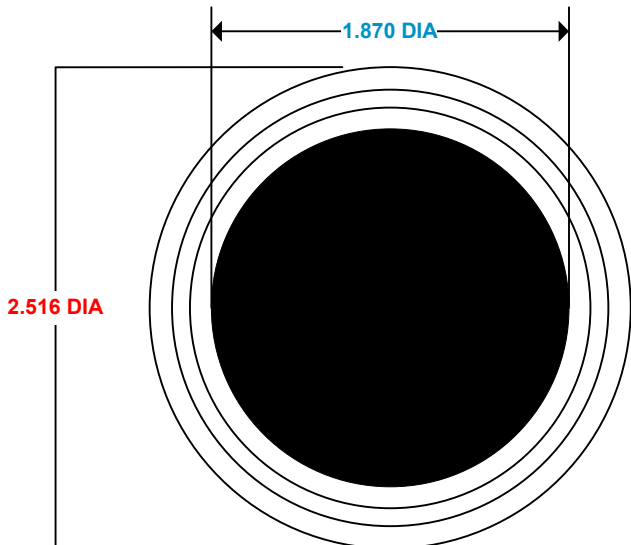

2" Tri-Clamp

sani-tech
west

321 Irving Drive
Oxnard, CA 93030
(800) 726-4835
www.sani-techwest.com